

FIRE ORDER

Actions to be taken in case of fire

- 1 R**escue
Rescue/Assist anyone in immediate danger
- 2 A**lert
Activate the nearest manual call point
inform Fire & Security Control Room
- 3 C**ontain
Extinguish the FIRE if possible by available Fire Equipment
Contain the Fire by closing the doors
- 4 E**vacuate
Evacuate the area through the Safest Exit/Emergency Exit
Report at Assembly Point of headcount
While evacuating, use staircase only
Do not Re-entre the building until "All clear" signal is given by the authorities

LEGEND

	FIREMAN'S PHONE JACK		MANUAL CALL POINT
	YOU ARE HERE		FIRE HOSE CABINET
	FIRE STAIRCASE		FIRE EXTINGUISHER
	ESCAPE ROUTE		ASSEMBLY POINT

**IN CASE OF FIRE:
DO NOT USE
THE LIFT**

**USE THE
STAIRS**



SITE PLAN OVERVIEW

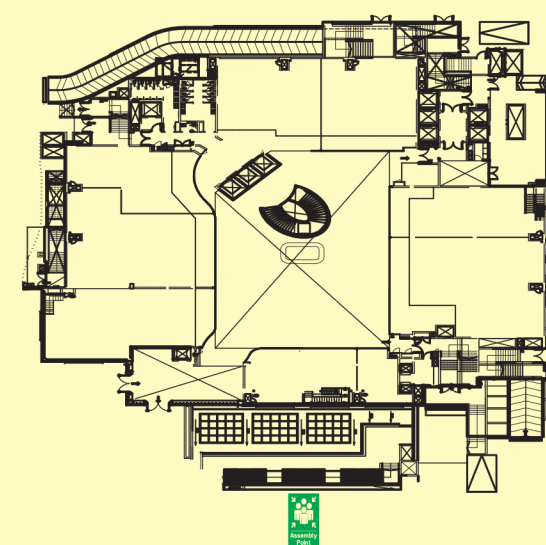

Emergency Contact Number

Help Desk:-
Emergency Contact Number:-
Security Control Room
Fire Control Room